

ITEM NO.	PART NUMBER	DESCRIPTION	MATERIAL
1	FP-HF3PT-2A	PLATE, 3PT MOUNT, UPPER, HF-CARRIER	3/8" HRS
2	FP-HF3PT-2B	PLATE, 3PT MOUNT, LOWER, HF-CARRIER	3/8" HRS

REVISIONS			
REV.	DESCRIPTION	DATE	APPROVED
A	INITIAL RELEASE	12/6/2016	

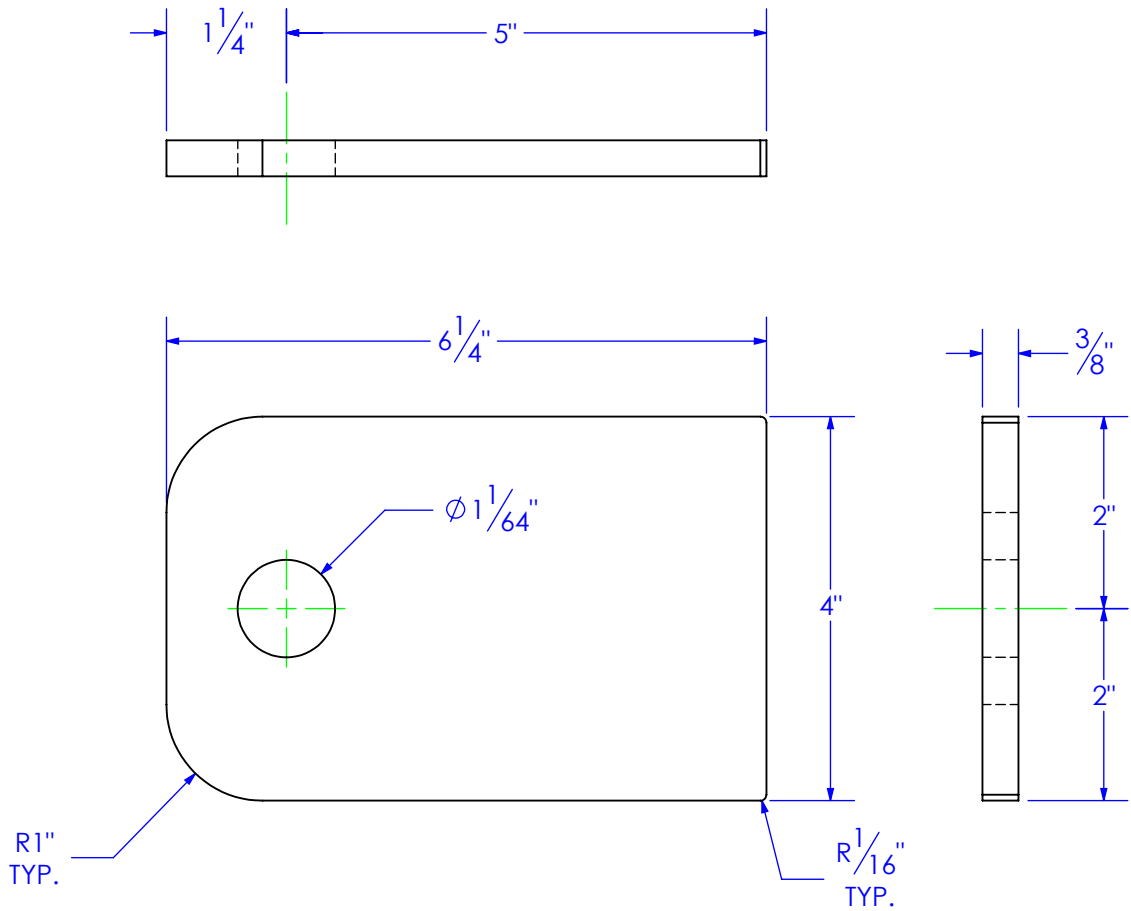

FP-HF3PT-2A  
PLATE, 3PT MOUNT,  
UPPER, HF-CARRIER

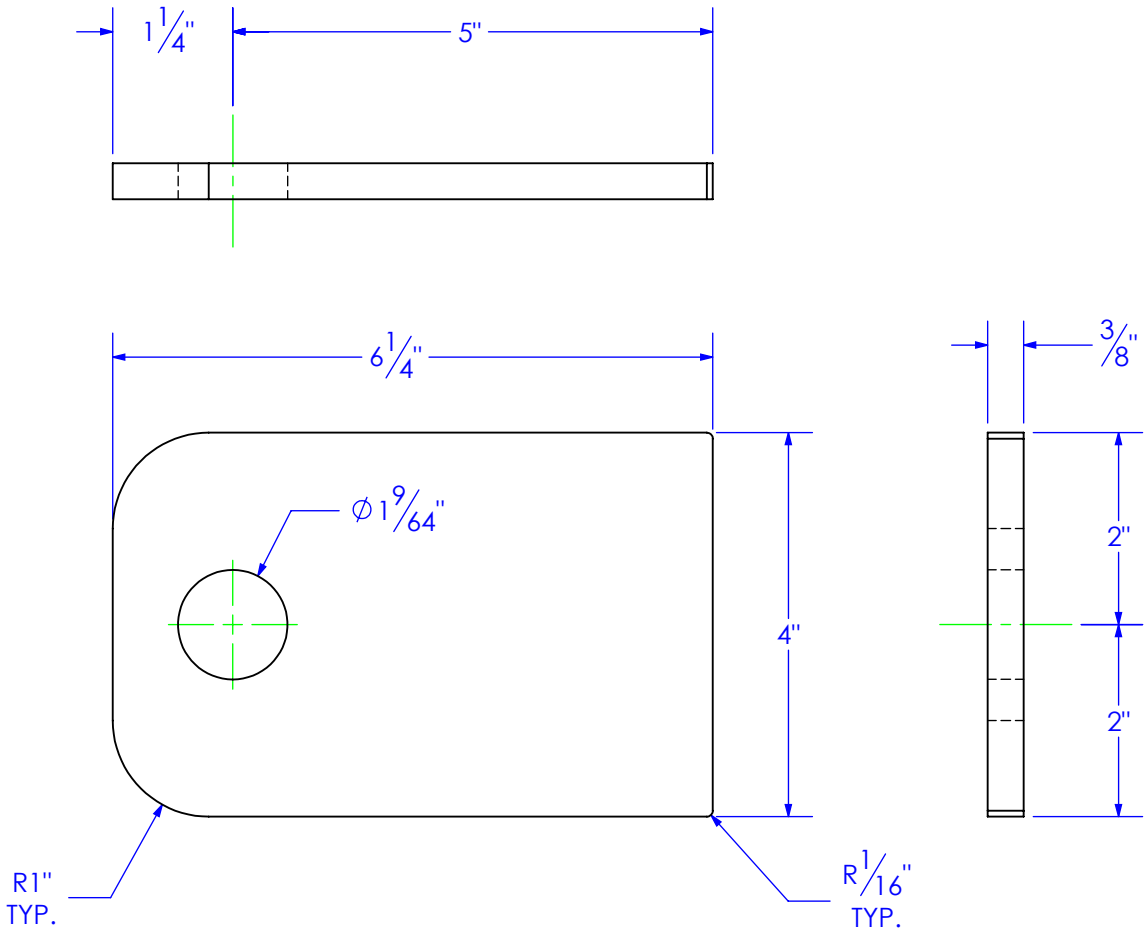

FP-HF3PT-2B  
PLATE, 3PT MOUNT,  
LOWER, HF-CARRIER

NOTE:  
OBSERVE HOLE SIZES BETWEEN UPPER AND  
LOWER PLATES.

PROPRIETARY AND CONFIDENTIAL  
THE INFORMATION CONTAINED IN THIS  
DRAWING IS THE SOLE PROPERTY OF TRIPLE  
C INC. ANY REPRODUCTION IN PART OR  
AS A WHOLE WITHOUT THE WRITTEN  
PERMISSION OF TRIPLE C, INC IS PROHIBITED.

UNLESS OTHERWISE SPECIFIED:  
DIMENSIONS ARE IN INCHES  
TOLERANCES:  
FRACTIONAL  $\pm 1/16$   
ANGULAR: MACH  $\pm 1$  BEND  $\pm$   
TWO PLACE DECIMAL  $\pm 010$   
THREE PLACE DECIMAL  $\pm 005$   
MATERIAL 3/8" HRS.  
DO NOT SCALE DRAWING

	NAME	DATE
DRAWN	ETHAN	12/6/2016
PART #		
ASM #		
COMMENTS:		
	PLATES, 3PT MOUNT, UPPER & LOWER, HF- CARRIER	

P.O. BOX 248, SABETHA, KS 66534 (785) 284-3674 FAX (785) 284-3931		
<b>TRIPLE C</b> INC		
SIZE <b>B</b>	DWG. NO. <b>30-1509</b>	REV <b>A</b>
SCALE: 1:2	WEIGHT: 2.53	SHEET 1 OF 1